

CRICKETERS, MILL GREEN ROAD, FRYERNING CM4 0JD

APPENDIX 2

Premises Licence

(issued 19 April 2018 - Redacted)

OS Maps & Images

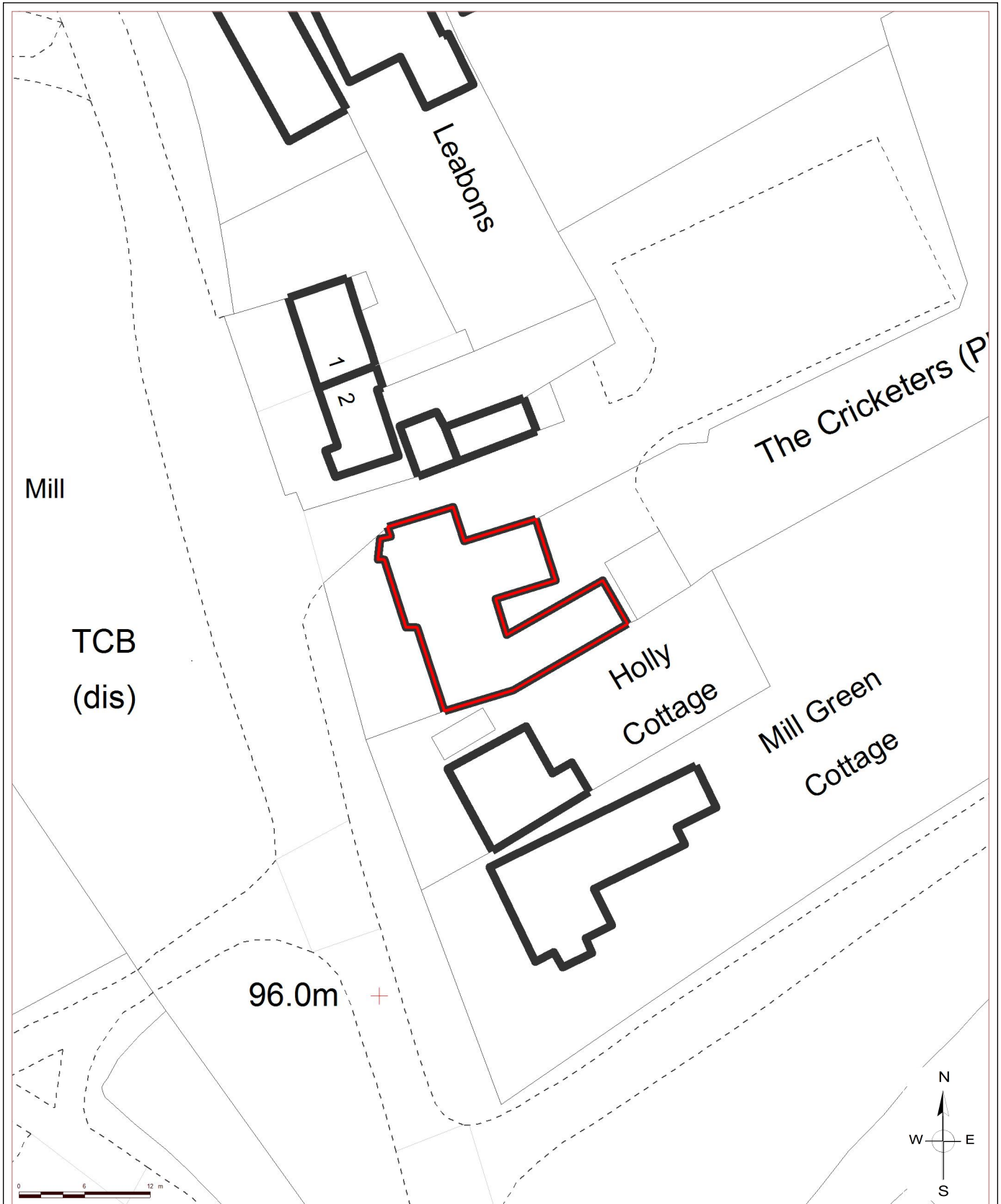

THE CRICKETERS, MILL GREEN ROAD, FRYERNING CM4 0RH



Drawing No. :
 Scale at A4 : 1:500
 Drawn by : OSJ
 Service : ICT
 Date : 27th August 2020

© Crown copyright and database rights 2020 Ordnance Survey 100018309

Jonathan Stephenson
 Chief Executive
 Brentwood Borough Council
 Town Hall, Ingrave Road
 Brentwood, CM15 8AY
 Tel.: (01277) 312500

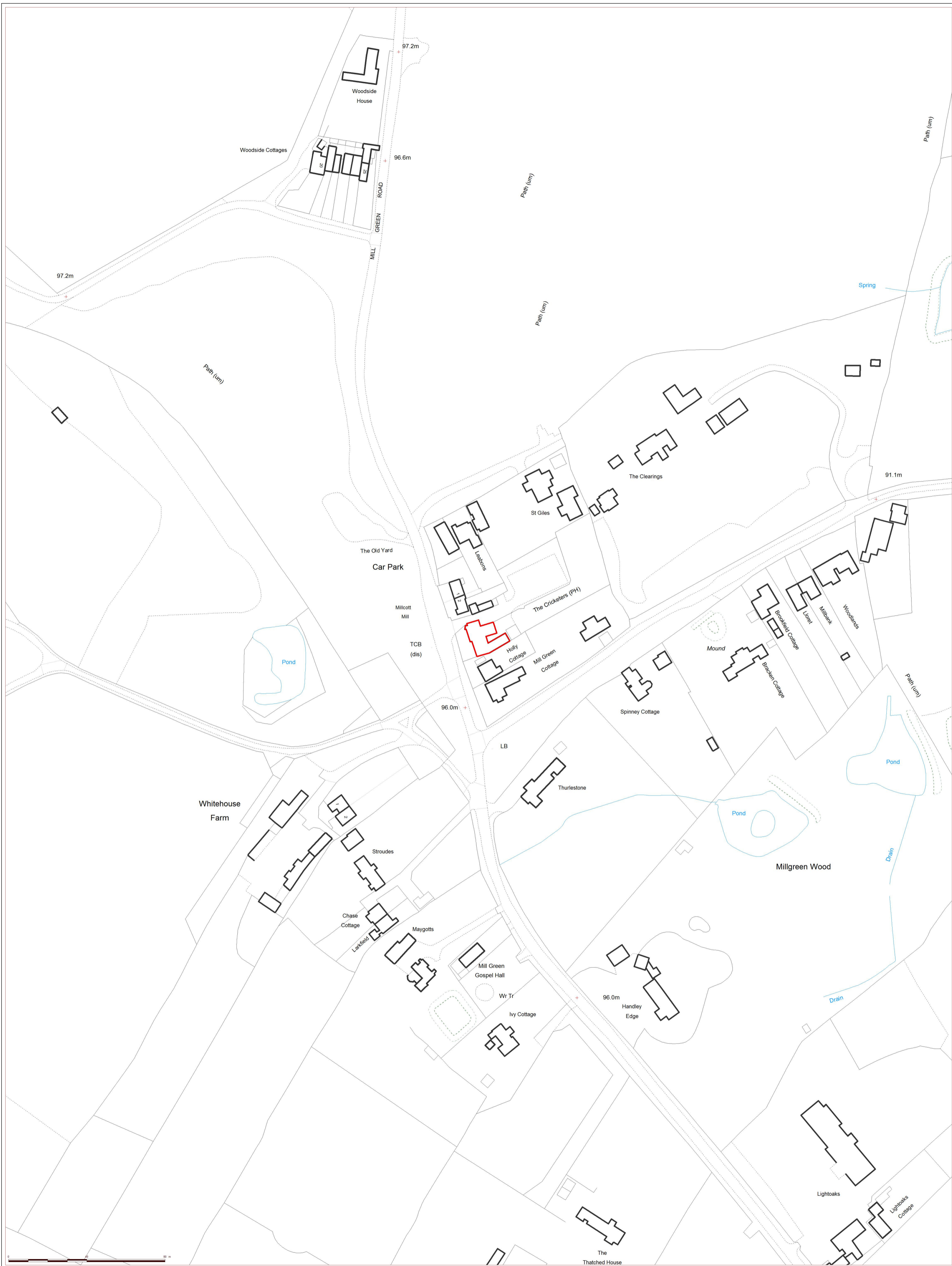

THE CRICKETERS, MILL GREEN ROAD, FRYERNING CM4 0RH

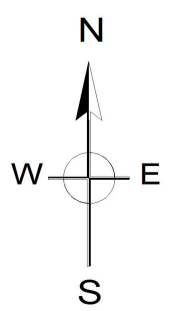

Drawing No. :
 Scale at A0 : 1:1250
 Drawn by : OSJ
 Service : ICT
 Date : 27th August 2020

Philip Ruck
 Chief Executive
 Brentwood Borough Council
 Town Hall, Ingrave Road
 Brentwood, CM15 8AY
 Tel.: (01277) 312500



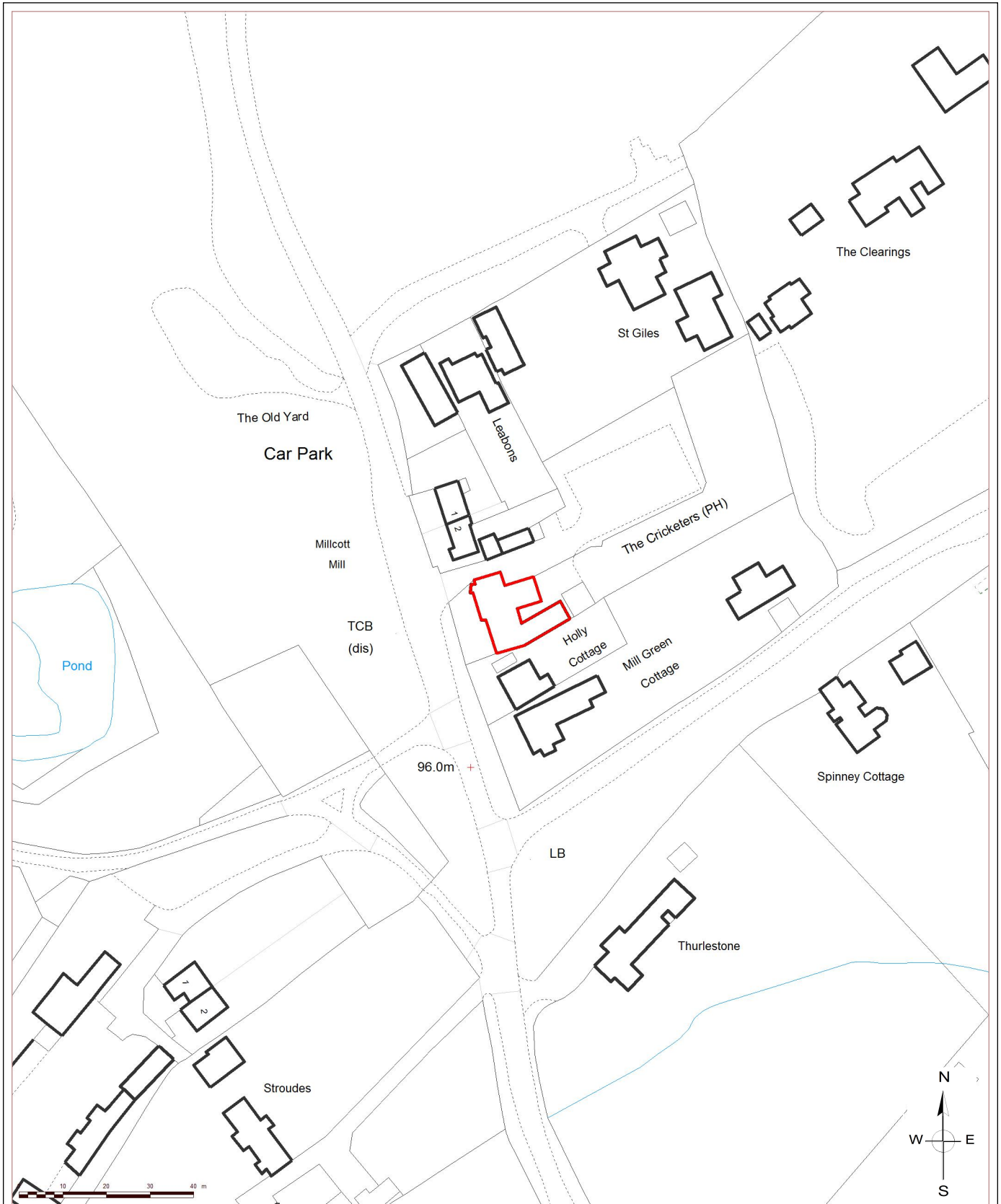

THE CRICKETERS, MILL GREEN ROAD, FRYERNING CM4 0RH



Drawing No. :
 Scale at A4 : 1:1250
 Drawn by : OSJ
 Service : ICT
 Date : 27th August 2020

© Crown copyright and database rights 2020 Ordnance Survey 100018309

Jonathan Stephenson
 Chief Executive
 Brentwood Borough Council
 Town Hall, Ingrave Road
 Brentwood, CM15 8AY
 Tel.: (01277) 312500



THE CRICKETERS, MILL GREEN ROAD, FRYERNING CM4 0RH



Drawing No. :
 Scale at A4 : 1:2500
 Drawn by : OSJ
 Service : ICT
 Date : 27th August 2020

© Crown copyright and database rights 2020 Ordnance Survey 100018309

Jonathan Stephenson
 Chief Executive
 Brentwood Borough Council
 Town Hall, Ingrave Road
 Brentwood, CM15 8AY
 Tel.: (01277) 312500

Premises Licence

| | |
|--------------------------------|------------------------|
| Premises Licence Number | PRM_081 |
| Application Number | 18/00017/LAPRE |
| Date of Issue | 18th April 2018 |

Part 1 – Premises Details

Postal address of premises, or if none, ordnance survey map reference or description, including Post Town, Post Code

**The Cricketers
Mill Green Road
Ingatstone And Fryerning
Ingatstone
Essex
CM4 0JD**

Telephone number
01277 352400

Where the licence is time limited the dates

Licensable activities authorised by the licence

**Performance of Dance
Performance of Live music
Playing of Recorded music
Provision of Late Night Refreshments
Sale by Retail of Alcohol**

Times the licence authorises the carrying out of licensable activities

Performance of Dance

| | |
|------------------|----------------------|
| Monday | 11:00 - 23:00 |
| Tuesday | 11:00 - 23:00 |
| Wednesday | 11:00 - 23:00 |
| Thursday | 11:00 - 23:00 |
| Friday | 11:00 - 23:00 |
| Saturday | 11:00 - 23:00 |
| Sunday | 11:00 - 23:00 |

**Christmas Eve, Thursdays preceding Bank Holiday weekends &
Sundays preceding Bank Holidays, St David's Day -1st March, St
Patricks Day -17th March, St Georges Day -23rd April, St Andrews
Day 30th November & Valentine's Day 14th February 11.00 to 00.00**

Performance of Live music

| | |
|------------------|----------------------|
| Monday | 11:00 - 23:00 |
| Tuesday | 11:00 - 23:00 |
| Wednesday | 11:00 - 23:00 |
| Thursday | 11:00 - 23:00 |
| Friday | 11:00 - 23:30 |
| Saturday | 11:00 - 23:30 |
| Sunday | 11:00 - 23:30 |

**Christmas Eve, Thursdays preceding Bank Holiday weekends & Sundays preceding Bank Holidays, St David's Day -1st March, St Patricks Day -17th March, St Georges Day -23rd April, St Andrews Day 30th November & Valentine's Day 14th February 11.00 to 00.00
New Year's Eve 23:00 to 01:30 the following day**

Playing of Recorded music

| | |
|------------------|----------------------|
| Monday | 11:00 - 23:00 |
| Tuesday | 11:00 - 23:00 |
| Wednesday | 11:00 - 23:00 |
| Thursday | 11:00 - 23:00 |
| Friday | 11:00 - 23:30 |
| Saturday | 11:00 - 23:30 |
| Sunday | 11:00 - 23:30 |

**Christmas Eve, Thursdays preceding Bank Holiday weekends & Sundays preceding Bank Holidays, St David's Day -1st March, St Patricks Day -17th March, St Georges Day -23rd April, St Andrews Day 30th November & Valentine's Day 14th February 11.00 to 00.00
New Year's Eve 23:00 to 01:30 the following day**

Provision of Late Night Refreshments

| | |
|-----------------|----------------------|
| Friday | 23:00 - 00:00 |
| Saturday | 23:00 - 00:00 |

Christmas Eve, Thursdays preceding Bank Holiday weekends & Sundays preceding Bank Holidays, St David's Day -1st March, St Patricks Day -17th March, St Georges Day -23rd April, St Andrews Day 30th November & Valentine's Day 14th February 11.00 to 00.00

Sale by Retail of Alcohol

| | |
|------------------|----------------------|
| Monday | 08:30 - 23:00 |
| Tuesday | 08:30 - 23:00 |
| Wednesday | 08:30 - 23:00 |
| Thursday | 08:30 - 23:00 |
| Friday | 08:30 - 00:00 |
| Saturday | 08:30 - 00:00 |
| Sunday | 08:30 - 00:00 |

**Christmas Eve, Thursdays preceding Bank Holiday weekends & Sundays preceding Bank Holidays, St David's Day -1st March, St Patricks Day -17th March, St Georges Day -23rd April, St Andrews Day 30th November & Valentine's Day 14th February 11.00 to 00.00
New Year's Eve 11:00 to 01:30 the following day**

The opening hours of the premises

| | |
|------------------|----------------------|
| Monday | 08:30 - 23:30 |
| Tuesday | 08:30 - 23:30 |
| Wednesday | 08:30 - 23:30 |
| Thursday | 08:30 - 23:30 |
| Friday | 08:30 - 00:30 |
| Saturday | 08:30 - 00:30 |
| Sunday | 08:30 - 00:30 |

Christmas Eve, Thursdays preceding Bank Holiday weekends & Sundays preceding Bank Holidays, St David's Day -1st March, St Patricks Day -17th March, St Georges Day -23rd April, St Andrews Day 30th November & Valentine's Day 14th February 11.00 to 00.30

New Year's Eve until 02:00am the following day

Where the licence authorises supplies of alcohol whether these are on and / or off supplies

Alcohol is supplied for consumption both on and off the Premise

Part 2

Name, (registered) address, telephone number and email (where relevant) of holder of premises licence

Gray & Sons (Chelmsford) Limited
Rignals Lane
Galleywood
Chelmsford
CM2 8RE

Registered number of holder, for example company number, charity number (where applicable)

Company Number **1066417**

Name, address and telephone number of designated premises supervisor where the premises licence authorises for the supply of alcohol

Mr Rupert Cherryman

Personal licence number and issuing authority of personal licence held by designated premises supervisor where the premises licence authorises for the supply of alcohol

Personal Licence Number: EZ16/00749/LAPER
Licensing Authority: Chelmsford Borough Council

Annex 1 – Mandatory conditions

- 1** No supply of alcohol may be made under this licence
 - a)** At a time when there is no designated supervisor in respect of it or,
 - b)** At a time when the designated premises supervisor does not hold a personal licence or his personal licence is suspended

- 2** Every supply of alcohol made under this licence must be made or authorised by a person who holds a personal licence.

- 3** (1) The premises licence holder or club premises certificate holder must ensure that an age verification policy is adopted in respect of the premises in relation to the sale or supply of alcohol.

(2) The designated premises supervisor in relation to the premises licence must ensure that the supply of alcohol at the premises is carried on in accordance with the age verification policy.

(3) The policy must require individuals who appear to the responsible person to be under 18 years of age (or such older age as may be specified in the policy) to produce on request, before being served alcohol, identification bearing their photograph, date of birth and either—
 - (a)** a holographic mark, or .
 - (b)** an ultraviolet feature.

- 4** (A). A relevant person shall ensure that no alcohol is sold or supplied for consumption on or off the premises for a price which is less than the permitted price.

(B).For the purposes of the condition set out in paragraph 1 -
 - (a)** "duty" is to be construed in accordance with the Alcoholic Liquor Duties Act 1979;
 - (b)** "permitted price" is the price found by applying the formula where-

$$P = D + (D \times V)$$
 - (i)** P is the permitted price,
 - (ii)** D is the amount of duty chargeable in relation to the alcohol as if the duty were charged on the date of the sale or supply of the alcohol, and
 - (iii)** V is the rate of value added tax chargeable in relation to the alcohol as if the value added tax were charged on the date of the sale or supply of the alcohol;
 - (c)** "relevant person" means, in relation to premises in respect of which there is in force a premises licence-
 - (i)** the holder of the premises licence,
 - (ii)** the designated premises supervisor (if any) in respect of such a licence, or
 - (iii)** the personal licence holder who makes or authorises a supply of alcohol under such a licence;

(d) "relevant person" means, in relation to premises in respect of which there is in force a club premises certificate, any member or officer of the club present on the premises in a capacity which enables the member or officer to prevent the supply in question; and

(e) "valued added tax" means value added tax charged in accordance with the Value Added Tax Act 1994.

5 (1) The responsible person must ensure that staff on relevant premises do not carry out, arrange or participate in any irresponsible promotions in relation to the premises.

(2) In this paragraph, an irresponsible promotion means any one or more of the following activities, or substantially similar activities, carried on for the purpose of encouraging the sale or supply of alcohol for consumption on the premises—

(a) games or other activities which require or encourage, or are designed to require or encourage, individuals to— .

(i) drink a quantity of alcohol within a time limit (other than to drink alcohol sold or supplied on the premises before the cessation of the period in which the responsible person is authorised to sell or supply alcohol), or .

(ii) drink as much alcohol as possible (whether within a time limit or otherwise); .

(b) provision of unlimited or unspecified quantities of alcohol free or for a fixed or discounted fee to the public or to a group defined by a particular characteristic in a manner which carries a significant risk of undermining a licensing objective; .

(c) provision of free or discounted alcohol or any other thing as a prize to encourage or reward the purchase and consumption of alcohol over a period of 24 hours or less in a manner which carries a significant risk of undermining a licensing objective; .

(d) selling or supplying alcohol in association with promotional posters or flyers on, or in the vicinity of, the premises which can reasonably be considered to condone, encourage or glamorise anti-social behaviour or to refer to the effects of drunkenness in any favourable manner; .

(e) dispensing alcohol directly by one person into the mouth of another (other than where that other person is unable to drink without assistance by reason of disability).

6 The responsible person must ensure that free potable water is provided on request to customers where it is reasonably available

7 The responsible person must ensure that—

(a) where any of the following alcoholic drinks is sold or supplied for consumption on the premises (other than alcoholic drinks sold or supplied having been made up in advance ready for sale or supply in a securely closed container) it is available to customers in the following measures—

- (i) beer or cider: ½ pint;**
- (ii) gin, rum, vodka or whisky: 25 ml or 35 ml; and,**
- (ii) still wine in a glass: 125 ml;**

(b) these measures are displayed in a menu, price list or other printed material which is available to customers on the premises; and .

(c) where a customer does not in relation to a sale of alcohol specify the quantity of alcohol to be sold, the customer is made aware that these measures are available."

Annex 2 – Conditions consistent with the Operating Schedule

- 1 All external areas of the Licensed Premises shall be cleared of customers no later than 23:00 every night except for the enclosed rear courtyard which shall be cleared of customers by midnight and shall be periodically supervised so as to keep noise to reasonable levels. Adequate notices shall be displayed to inform patrons of this requirement. After 23:00 (midnight for rear courtyard) the designated smoking area shall be for 'smoking only' and patrons permitted to temporarily leave and then re-enter the premises shall not be permitted to take drinks or glass containers with them. Notices to that effect will be displayed at the premises exits. The premises licence holder or nominated person will take reasonable steps to prevent the consumption of any drinks in this area.**
- 2 All amplified music shall be controlled by a suitable noise limiter. The noise limiter shall be installed and operate throughout the performance of live or recorded music at the premises and be capable of preventing music noise levels exceeding agreed limits, which shall be set at a level to be agreed with the Pollution Team and kept under the control of management. No amplified sound shall be played externally and no music or speech shall be relayed via external speakers, other than for events where the prior approval of the licensing authority has been obtained.**
- 3 Patrons shall be encouraged to leave quietly. The Premises Licence Holder or nominated person shall ensure that suitably clear and legible notices must be prominently displayed at all exits requesting customers to respect local residents and make as little noise as possible when leaving the premises. These signs shall be a minimum size of 200 x 150 mm. Patrons will be asked not to stand around talking in the street outside the premises or any car park; and asked to leave the vicinity quickly and quietly.**
- 4 No children under the age of 16 years shall be allowed on the premises unless accompanied by a supervising adult.**
- 5 A Challenge 25 scheme shall be operated, whereby any person who appears to be under the age of 25 years of age is required to produce on request an item which meets the mandatory age verification requirement and is either a:
 - i. Passport;**
 - ii. European Union photocard driving licence;**
 - iii. Proof of age card bearing the PASS Hologram;****
- 6 The premises shall clearly display signs at the point of sale and in areas where alcohol is displayed advising customers that a Challenge 25 policy is in force. Such signs shall be a minimum size of 200 x 150mm.**
- 7 A refusals record shall be maintained at the premises which details all refusals to sell alcohol. Each entry shall, as a minimum, record the date and time of the refusal and the name of the staff member refusing the sale. All entries must be made within 4 hours of the refusal and the record must be made immediately available to police or licensing authority staff upon reasonable request.**

8 The premises shall have installed and maintain a closed circuit television surveillance (CCTV) system which at all times complies with the below requirements:

i. CCTV will be provided in the form a recordable system, capable of providing pictures of evidential quality in all lighting conditions particularly facial recognition;

ii. CCTV cameras shall cover all public areas including all entrances and exits;

iii. Equipment must be maintained in good working order, be correctly time and date stamped, recordings must be kept in good working order and kept for a minimum period of 31 days;

iv. At all times, whilst the premises is open for licensable activities, there are members of staff available with the absolute minimum of delay and within 4 hours to provide viewable copies of recordings to the police or licensing authority staff upon reasonable request;

v. The recording equipment and data storage devices shall be kept in a secure environment and fitted with security functions (such as passwords) to prevent recordings being tampered with;

vi. An operational daily log report must be maintained endorsed by signature, indicating the system has been checked and is compliant: in the event of any failings these are to be recorded immediately.

9 Signs must be displayed at all entrances and exits advising customers that CCTV is operating at the premises and shall be minimum size of 200 x 150 mm

Annex 3 – Conditions attached after a hearing by the licensing authority

Annex 4 – Plans

The licence is granted subject to plan supplied with the application dated 16th March 2018 for Cricketers, Mill Green Road, Ingatestone

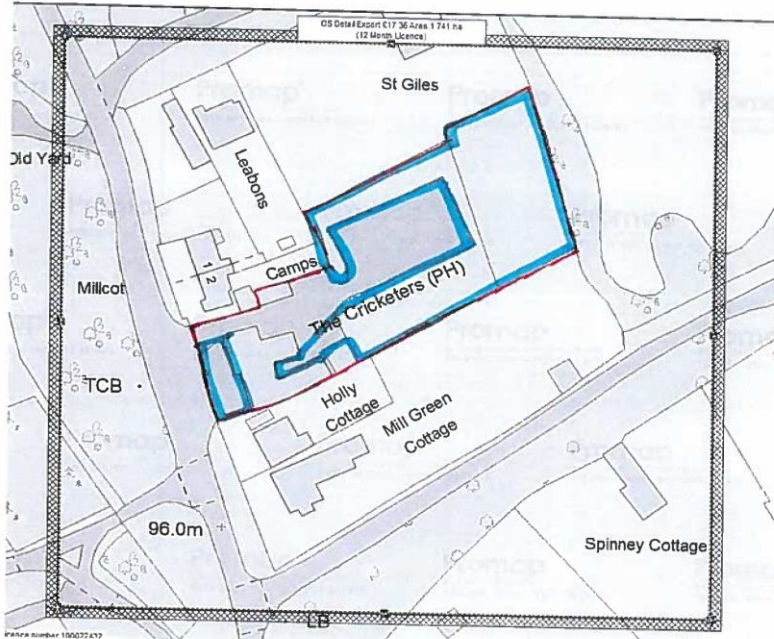

Cricketers
Mill Green Road
Ingatestone
Essex
CM4 0JD.

CRICKETERS
NINE GREEN ROAD, INGATESTONE
CM4 0JD

PUBLIC ENTRANCE/EXIT

▭ LICENSABLE ACTIVITIES

▭ STAFF ONLY.

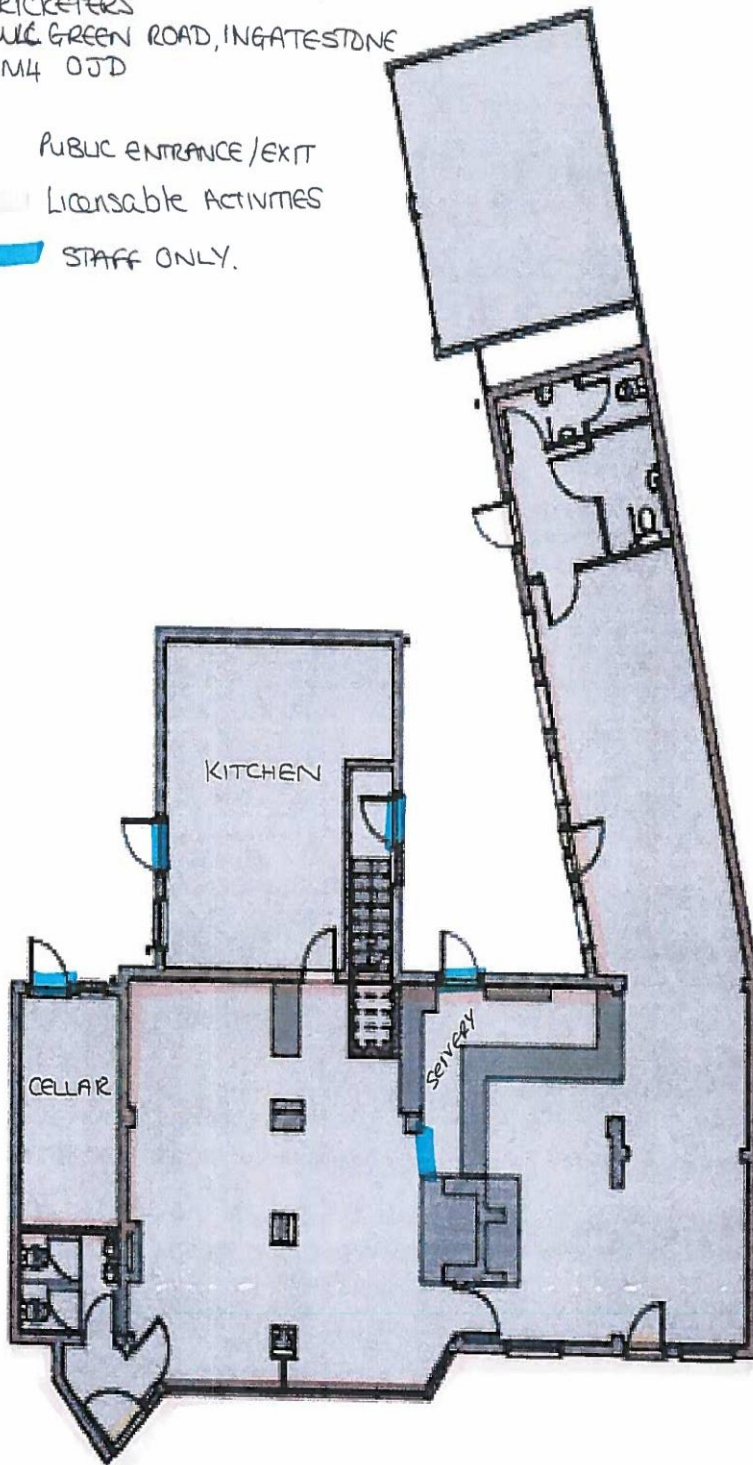



Premises Licence Summary

| | |
|--------------------------------|------------------------|
| Premises Licence Number | PRM_081 |
| Application Number | 18/00017/LAPRE |
| Date of Issue | 18th April 2018 |

Part 1 – Premises Details

Postal address of premises, or if none, ordnance survey map reference or description, including Post Town, Post Code

**The Cricketers
Mill Green Road
Ingatestone And Fryerning
Ingatestone
Essex CM4 0JD**

Telephone number
01277 352400

Where the licence is time limited the dates

Licensable activities authorised by the licence

**Performance of Dance
Performance of Live music
Playing of Recorded music
Provision of Late Night Refreshments
Sale by Retail of Alcohol**

Times the licence authorises the carrying out of licensable activities

Performance of Dance

| | |
|------------------|----------------------|
| Monday | 11:00 - 23:00 |
| Tuesday | 11:00 - 23:00 |
| Wednesday | 11:00 - 23:00 |
| Thursday | 11:00 - 23:00 |
| Friday | 11:00 - 23:00 |
| Saturday | 11:00 - 23:00 |
| Sunday | 11:00 - 23:00 |

**Christmas Eve, Thursdays preceding Bank Holiday weekends &
Sundays preceding Bank Holidays, St David's Day -1st March, St
Patricks Day -17th March, St Georges Day -23rd April, St Andrews
Day 30th November & Valentine's Day 14th February 11.00 to 00.00**

Performance of Live music

| | |
|------------------|----------------------|
| Monday | 11:00 - 23:00 |
| Tuesday | 11:00 - 23:00 |
| Wednesday | 11:00 - 23:00 |
| Thursday | 11:00 - 23:00 |
| Friday | 11:00 - 23:30 |
| Saturday | 11:00 - 23:30 |
| Sunday | 11:00 - 23:30 |

**Christmas Eve, Thursdays preceding Bank Holiday weekends & Sundays preceding Bank Holidays, St David's Day -1st March, St Patricks Day -17th March, St Georges Day -23rd April, St Andrews Day 30th November & Valentine's Day 14th February 11.00 to 00.00
New Year's Eve 23:00 to 01:30 the following day**

Playing of Recorded music

| | |
|------------------|----------------------|
| Monday | 11:00 - 23:00 |
| Tuesday | 11:00 - 23:00 |
| Wednesday | 11:00 - 23:00 |
| Thursday | 11:00 - 23:00 |
| Friday | 11:00 - 23:30 |
| Saturday | 11:00 - 23:30 |
| Sunday | 11:00 - 23:30 |

**Christmas Eve, Thursdays preceding Bank Holiday weekends & Sundays preceding Bank Holidays, St David's Day -1st March, St Patricks Day -17th March, St Georges Day -23rd April, St Andrews Day 30th November & Valentine's Day 14th February 11.00 to 00.00
New Year's Eve 23:00 to 01:30 the following day**

Provision of Late Night Refreshments

| | |
|-----------------|----------------------|
| Friday | 23:00 - 00:00 |
| Saturday | 23:00 - 00:00 |

Christmas Eve, Thursdays preceding Bank Holiday weekends & Sundays preceding Bank Holidays, St David's Day -1st March, St Patricks Day -17th March, St Georges Day -23rd April, St Andrews Day 30th November & Valentine's Day 14th February 11.00 to 00.00

Sale by Retail of Alcohol

| | |
|------------------|----------------------|
| Monday | 08:30 - 23:00 |
| Tuesday | 08:30 - 23:00 |
| Wednesday | 08:30 - 23:00 |
| Thursday | 08:30 - 23:00 |
| Friday | 08:30 - 00:00 |
| Saturday | 08:30 - 00:00 |
| Sunday | 08:30 - 00:00 |

**Christmas Eve, Thursdays preceding Bank Holiday weekends & Sundays preceding Bank Holidays, St David's Day -1st March, St Patricks Day -17th March, St Georges Day -23rd April, St Andrews Day 30th November & Valentine's Day 14th February 11.00 to 00.00
New Year's Eve 11:00 to 01:30 the following day**

The opening hours of the premises

| | |
|------------------|----------------------|
| Monday | 08:30 - 23:30 |
| Tuesday | 08:30 - 23:30 |
| Wednesday | 08:30 - 23:30 |
| Thursday | 08:30 - 23:30 |
| Friday | 08:30 - 00:30 |
| Saturday | 08:30 - 00:30 |
| Sunday | 08:30 - 00:30 |

**Christmas Eve, Thursdays preceding Bank Holiday weekends & Sundays preceding Bank Holidays, St David's Day -1st March, St Patricks Day -17th March, St Georges Day -23rd April, St Andrews Day 30th November & Valentine's Day 14th February 11.00 to 00.30
New Year's Eve 11:00 to 02:00 the following day**

Where the licence authorises supplies of alcohol whether these are on and / or off supplies

Alcohol is supplied for consumption both on and off the Premise

Part 2

Name, (registered) address, telephone number and email (where relevant) of holder of premises licence

Gray & Sons (Chelmsford) Limited
Rignals Lane
Galleywood
Chelmsford
CM2 8RE

Registered number of holder, for example company number, charity number (where applicable)

Company Number **1066417**

Name of designated premises supervisor where the premises licence authorises for the supply of alcohol

Mr Rupert Cherryman

Personal licence number and issuing authority of personal licence held by designated premises supervisor where the premises licence authorises for the supply of alcohol

Personal Licence Number: EZ16/00749/LAPER
Licensing Authority: Chelmsford Borough Council